

## WARRANTY NOTICE:

There are **NO WARRANTIES**, either expressed or implied. Neither the seller nor manufacturer will be liable for any loss, damage or injury, direct or indirect, arising from the use or inability to determine the appropriate use of any product. Before any attempt at installation, all drawings and/or instruction sheets should be completely reviewed to determine the suitability of the product for its intended use. In this connection, the user assumes all responsibility and risk. We reserve the right to change specification without notice. Further, Chris Alston's Chassisworks, Inc., makes **NO GUARANTEE** in reference to any specific class legality of any component. **ALL PRODUCTS ARE INTENDED FOR RACING AND OFF-ROAD USE AND MAY NOT BE LEGALLY USED ON THE HIGHWAY.** The products offered for sale are true race-car components and, in all cases, require some fabrication skill. **NO PRODUCT OR SERVICE IS DESIGNED OR INTENDED TO PREVENT INJURY OR DEATH.**



Total Control Products  
A Chris Alston's Chassisworks, Inc. Brand  
8661 Younger Creek Drive  
Sacramento, CA 95828  
Phone: 916-388-0288  
Technical Support: [tcptech@cachassisworks.com](mailto:tcptech@cachassisworks.com)

7903-ISFT-01

REV 01/18/05

## INSTALLATION GUIDE



### Intermediate Shaft Set

For use with TCP Rack-&Pinion and  
OEM steering column (standard misalignment)

**P/N: TCP ISFT-01**

#### DESCRIPTION:

INTERMEDIATE SHAFT SET 3/4-DD x 3/4-20 x 10"  
STANDARD MISALIGNMENT

#### APPLICATIONS:

FITS '64-70 MUSTANG/COUGAR WITH OEM STEERING  
COLUMN

# PARTS LIST

Item	Part Number	Description	Qty
1	7900-094	Shaft 3/4"-DD x 10" Long	1
2	7900-UA10909	Universal Joint, 3/4-DD x 3/4-DD, 28°	1
3	7900-UA20109	Universal Joint, 3/4-DD x 3/4-20, 28°	1

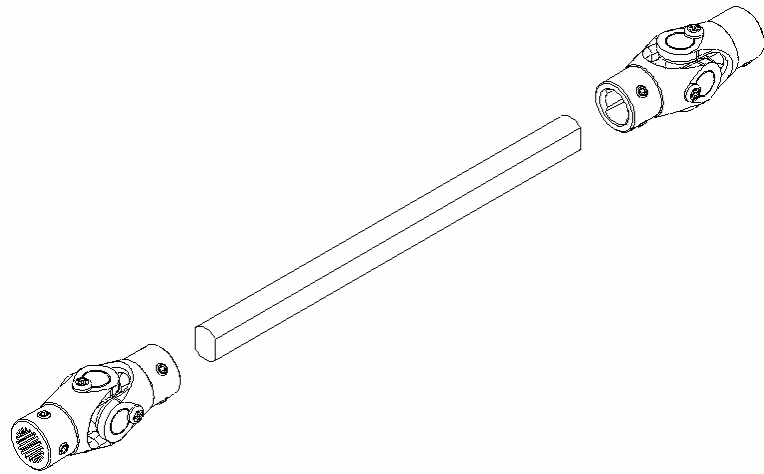

# INSTRUCTIONS

To proceed, the instructions for the steering column must be completed and the rack-&-pinion loosely bolted in place.

1. Place universal joint #7900-UA10909 onto the exposed 3/4"-DD steering shaft extending from the column.
  - a. 1" of shaft engagement is required.
  - b. Temporarily tighten setscrews just enough to hold the u-joint in place.
2. Place universal joint #7900-UA20109 onto the 3/4"-20 spline pinion shaft at the rack.

- a. 1" of shaft engagement is required.
  - b. Temporarily tighten setscrews just enough to hold the u-joint in place.
3. Angle the u-joints toward each other.
  - a. Measure the distance from point "A" to point "B" as shown in the illustration. This is your "cut to" length.
  - b. We recommend adding 1/4" to the measured length if you are unsure of the correct fit. The shaft can then be shortened after test fitting.

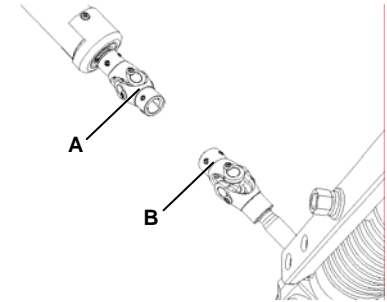

4. Place supplied shaft #7900-094 into a vise and cut square to the determined length.
  - a. File to remove any sharp edges.

General Intermediate Shaft Lengths (Verify measurement before cutting.)		
Rack	Engine	Length
Manual	Big Block	10"
Manual	Small Block	9"
Power	Big Block	6-1/8"
Power	Small Block	5-1/8"

Based on Mustang/Cougar applications.

5. Paint the cut end of the shaft to protect against rust.
6. The driver side end of the rack-&-pinion must be lowered to insert the correct length intermediate shaft between the u-joints.
  - a. Insert the shaft into the upper u-joint.
  - b. Insert the shaft into the lower u-joint as the rack-&-pinion is lifted back into position.
7. Snugly bolt the rack into place and verify that the shaft length and position are correct. Refer to illustration to right.
  - a. Once the length and position have been verified, apply a drop of medium strength Loctite™.
  - b. Tighten the setscrews to 15-17 lb. ft. using a 1/8" allen wrench.
8. Turn steering wheel to check for binding.



Shaft must not extend into open area of u-joint. Lengths exceeding 1" of engagement will cause u-joints to bind.